

標準納まり図

● 天端の納まり

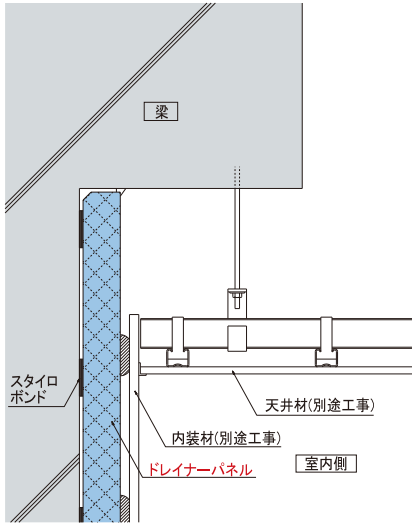

● 柱部の納まり(出隅・入隅)

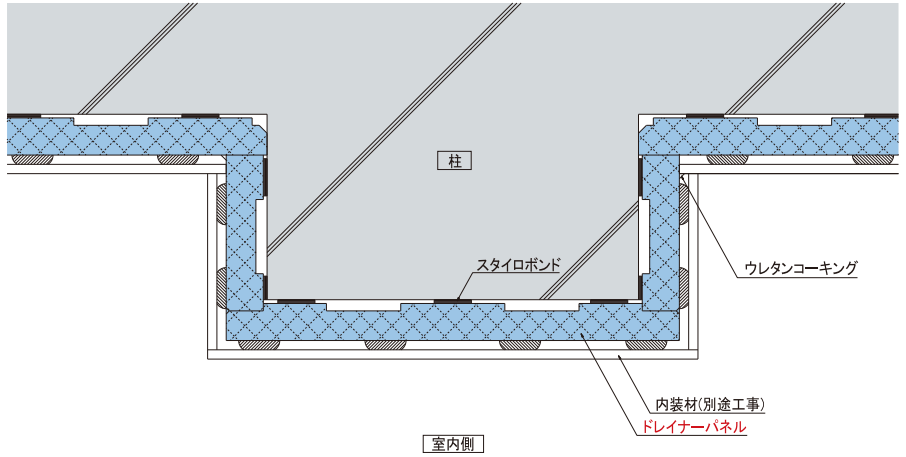

● 壁部の納まり

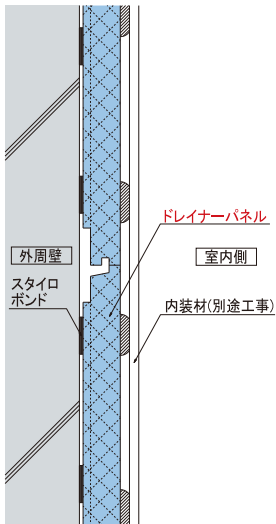

● パネル横目地

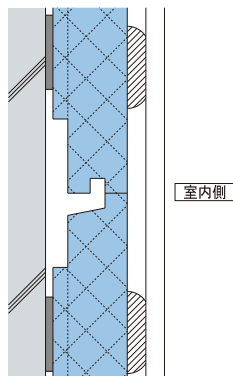

● パネル縦目地

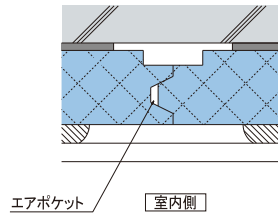

● 壁端部の納まり

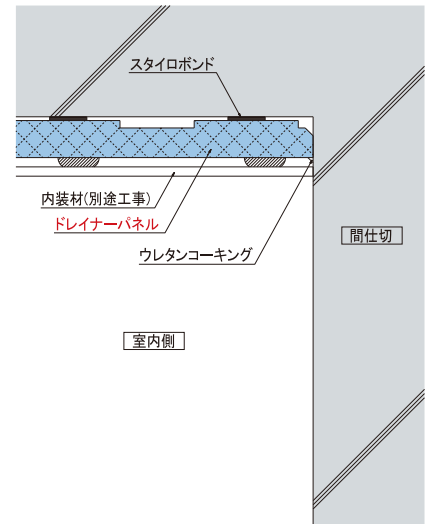

● 壁-基礎部の納まり(排水溝仕様)

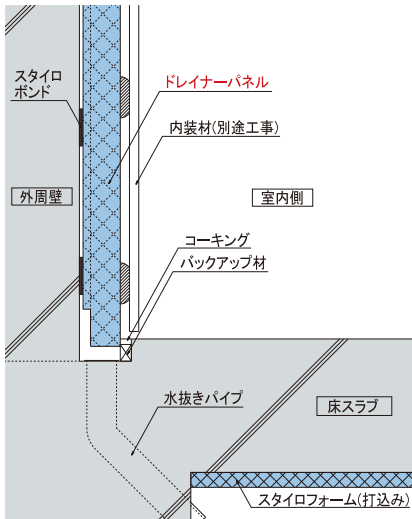

● 壁-基礎部の納まり(立上り仕様)

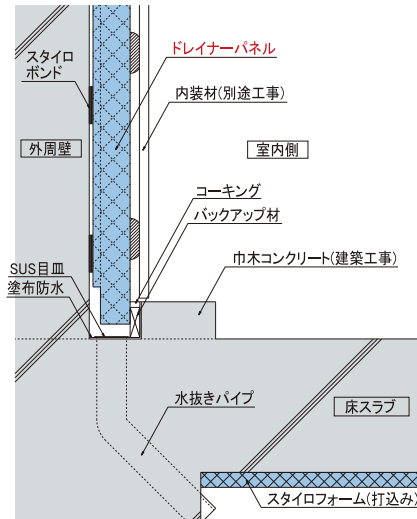

● 壁-基礎部の納まり(ドースライナー仕様)

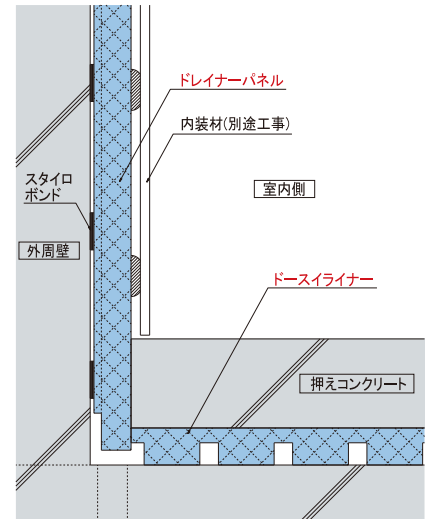



● 入隅部の納まり

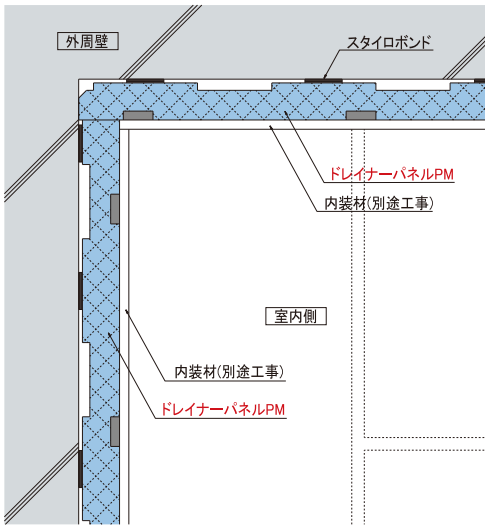

● 基礎-床部の納まり

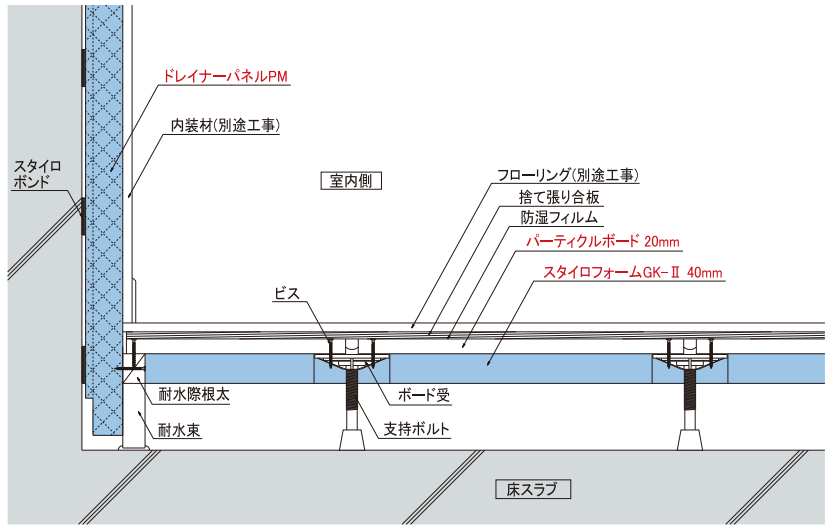

● 出隅部の納まり

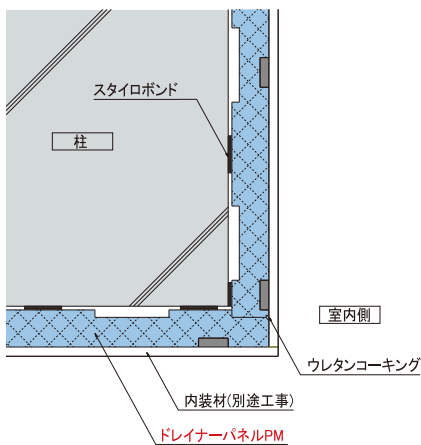

● 壁-基礎部の納まり (LGS仕様)

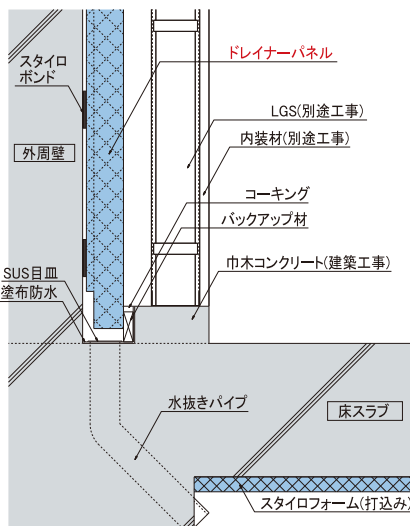

● 点検口の納まり

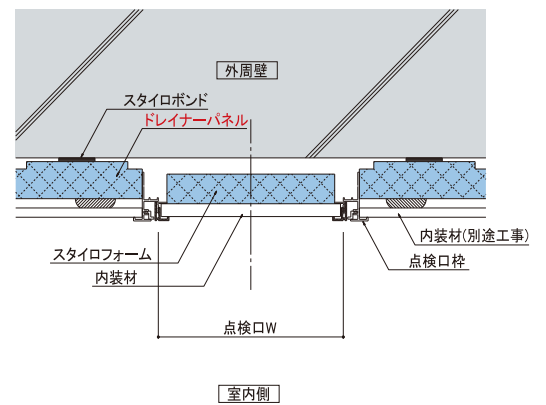

● 壁-基礎部の納まり (水抜きパイプスラブ貫通仕様)

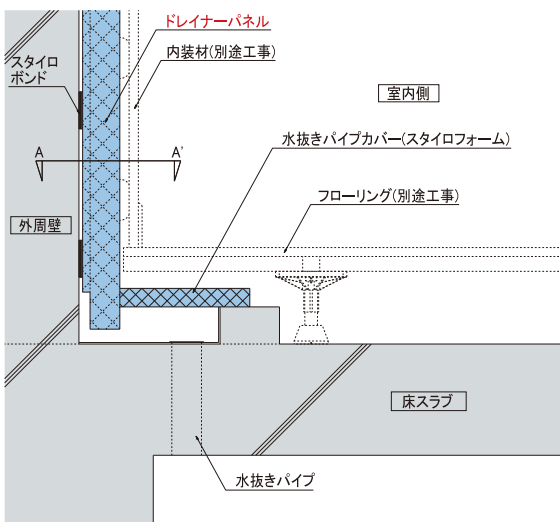

● A-A'

